



**SAN JOSÉ-EVERGREEN
COMMUNITY COLLEGE DISTRICT
POLICE DEPARTMENT**

SAN JOSÉ CITY COLLEGE

Criminal Offenses - On campus

<i>Criminal Offense</i>	<i>Total Occurrences – On Campus</i>		
	2020	2021	2022
a. Murder/Non-negligent manslaughter	0	0	0
b. Negligent manslaughter	0	0	0
c. Sex offenses - Forcible	0	0	0
d. Rape	0	0	0
e. Fondling	1	0	0
f. Sex offenses - Non-forcible	0	0	0
g. Incest	0	0	0
h. Statutory rape	0	0	0
i. Robbery	0	0	0
j. Aggravated assault	1	0	0
k. Burglary	0	4	14
l. Motor vehicle theft	0	0	0
m. Arson	0	0	0

Criminal Offenses – Public Property

<i>Criminal Offense</i>	<i>Total Occurrences – Public Property</i>		
	2020	2021	2022
a. Murder/Non-negligent manslaughter	0	0	0
b. Negligent manslaughter	0	0	0
c. Sex offenses - Forcible	0	0	0
d. Rape	0	0	0
e. Fondling	0	0	0
f. Sex offenses - Non-forcible	0	0	0
g. Incest	0	0	0
h. Statutory rape	0	0	0
i. Robbery	0	0	0
j. Aggravated assault	0	0	0
k. Burglary	0	0	0
l. Motor vehicle theft	2	1	0
m. Arson	0	0	0



SAN JOSÉ-EVERGREEN COMMUNITY COLLEGE DISTRICT POLICE DEPARTMENT

SAN JOSÉ CITY COLLEGE

<i>Hate Crimes - On campus</i>									
Occurrences of Hate crimes									
Criminal offense									
<i>Category of Bias for crimes reported in 2022</i>									
Criminal offense	2022 Total	Race	Religion	Sexual Orientation	Gender	Gender Identity	Disability	Ethnicity	National Origin
a. Murder/ Non-negligent manslaughter	0	0	0	0	0	0	0	0	0
d. Rape	0	0	0	0	0	0	0	0	0
e. Fondling	0	0	0	0	0	0	0	0	0
g. Incest	0	0	0	0	0	0	0	0	0
h. Statutory rape	0	0	0	0	0	0	0	0	0
i. Robbery	0	0	0	0	0	0	0	0	0
j. Aggravated assault	0	0	0	0	0	0	0	0	0
k. Burglary	0	0	0	0	0	0	0	0	0
l. Motor vehicle theft	0	0	0	0	0	0	0	0	0
m. Arson	0	0	0	0	0	0	0	0	0
n. Simple assault	0	0	0	0	0	0	0	0	0
o. Larceny-theft	0	0	0	0	0	0	0	0	0
p. Intimidation	0	0	0	0	0	0	0	0	0
q. Destruction/damage/ vandalism of property	0	0	0	0	0	0	0	0	0

<i>Hate Crimes - On campus</i>									
Occurrences of Hate crimes									
Criminal offense									
<i>Category of Bias for crimes reported in 2021</i>									
Criminal offense	2021 Total	Race	Religion	Sexual Orientation	Gender	Gender Identity	Disability	Ethnicity	National Origin
a. Murder/ Non-negligent manslaughter	0	0	0	0	0	0	0	0	0
d. Rape	0	0	0	0	0	0	0	0	0
e. Fondling	0	0	0	0	0	0	0	0	0
g. Incest	0	0	0	0	0	0	0	0	0
h. Statutory rape	0	0	0	0	0	0	0	0	0
i. Robbery	0	0	0	0	0	0	0	0	0
j. Aggravated assault	0	0	0	0	0	0	0	0	0
k. Burglary	0	0	0	0	0	0	0	0	0
l. Motor vehicle theft	0	0	0	0	0	0	0	0	0
m. Arson	0	0	0	0	0	0	0	0	0
n. Simple assault	0	0	0	0	0	0	0	0	0
o. Larceny-theft	0	0	0	0	0	0	0	0	0
p. Intimidation	0	0	0	0	0	0	0	0	0
q. Destruction/damage/ vandalism of property	0	0	0	0	0	0	0	0	0



SAN JOSÉ-EVERGREEN COMMUNITY COLLEGE DISTRICT POLICE DEPARTMENT

SAN JOSÉ CITY COLLEGE

<i>Hate Crimes - On campus</i>									
Occurrences of Hate crimes									
Criminal offense									
<i>Category of Bias for crimes reported in 2020</i>									
Criminal offense	2020 Total	Race	Religion	Sexual Orientation	Gender	Gender Identity	Disability	Ethnicity	National Origin
a. Murder/ Non-negligent manslaughter	0	0	0	0	0	0	0	0	0
d. Rape	0	0	0	0	0	0	0	0	0
e. Fondling	0	0	0	0	0	0	0	0	0
g. Incest	0	0	0	0	0	0	0	0	0
h. Statutory rape	0	0	0	0	0	0	0	0	0
i. Robbery	0	0	0	0	0	0	0	0	0
j. Aggravated assault	0	0	0	0	0	0	0	0	0
k. Burglary	0	0	0	0	0	0	0	0	0
l. Motor vehicle theft	0	0	0	0	0	0	0	0	0
m. Arson	0	0	0	0	0	0	0	0	0
n. Simple assault	0	0	0	0	0	0	0	0	0
o. Larceny-theft	0	0	0	0	0	0	0	0	0
p. Intimidation	0	0	0	0	1	0	0	0	0
q. Destruction/damage/ vandalism of property	0	0	0	0	0	0	0	0	0





SAN JOSÉ-EVERGREEN COMMUNITY COLLEGE DISTRICT POLICE DEPARTMENT

SAN JOSÉ CITY COLLEGE

<i>Hate Crimes – Public Property</i>									
Occurrences of Hate crimes									
Criminal offense									
<i>Category of Bias for crimes reported in 2022</i>									
Criminal offense	2022 Total	Race	Religion	Sexual Orientation	Gender	Gender Identity	Disability	Ethnicity	National Origin
a. Murder/ Non-negligent manslaughter	0	0	0	0	0	0	0	0	0
d. Rape	0	0	0	0	0	0	0	0	0
e. Fondling	0	0	0	0	0	0	0	0	0
g. Incest	0	0	0	0	0	0	0	0	0
h. Statutory rape	0	0	0	0	0	0	0	0	0
i. Robbery	0	0	0	0	0	0	0	0	0
j. Aggravated assault	0	0	0	0	0	0	0	0	0
k. Burglary	0	0	0	0	0	0	0	0	0
l. Motor vehicle theft	0	0	0	0	0	0	0	0	0
m. Arson	0	0	0	0	0	0	0	0	0
n. Simple assault	0	0	0	0	0	0	0	0	0
o. Larceny-theft	0	0	0	0	0	0	0	0	0
p. Intimidation	0	0	0	0	0	0	0	0	0
q. Destruction/damage/ vandalism of property	0	0	0	0	0	0	0	0	0

<i>Hate Crimes – Public Property</i>									
Occurrences of Hate crimes									
Criminal offense									
<i>Category of Bias for crimes reported in 2021</i>									
Criminal offense	2021 Total	Race	Religion	Sexual Orientation	Gender	Gender Identity	Disability	Ethnicity	National Origin
a. Murder/ Non-negligent manslaughter	0	0	0	0	0	0	0	0	0
d. Rape	0	0	0	0	0	0	0	0	0
e. Fondling	0	0	0	0	0	0	0	0	0
g. Incest	0	0	0	0	0	0	0	0	0
h. Statutory rape	0	0	0	0	0	0	0	0	0
i. Robbery	0	0	0	0	0	0	0	0	0
j. Aggravated assault	0	0	0	0	0	0	0	0	0
k. Burglary	0	0	0	0	0	0	0	0	0
l. Motor vehicle theft	0	0	0	0	0	0	0	0	0
m. Arson	0	0	0	0	0	0	0	0	0
n. Simple assault	0	0	0	0	0	0	0	0	0
o. Larceny-theft	0	0	0	0	0	0	0	0	0
p. Intimidation	0	0	0	0	0	0	0	0	0
q. Destruction/damage/ vandalism of property	0	0	0	0	0	0	0	0	0



SAN JOSÉ-EVERGREEN COMMUNITY COLLEGE DISTRICT POLICE DEPARTMENT

SAN JOSÉ CITY COLLEGE

<i>Hate Crimes – Public Property</i>									
Occurrences of Hate crimes									
Criminal offense									
<i>Category of Bias for crimes reported in 2020</i>									
Criminal offense	2020 Total	Race	Religion	Sexual Orientation	Gender	Gender Identity	Disability	Ethnicity	National Origin
a. Murder/ Non-negligent manslaughter	0	0	0	0	0	0	0	0	0
d. Rape	0	0	0	0	0	0	0	0	0
e. Fondling	0	0	0	0	0	0	0	0	0
g. Incest	0	0	0	0	0	0	0	0	0
h. Statutory rape	0	0	0	0	0	0	0	0	0
i. Robbery	0	0	0	0	0	0	0	0	0
j. Aggravated assault	0	0	0	0	0	0	0	0	0
k. Burglary	0	0	0	0	0	0	0	0	0
l. Motor vehicle theft	0	0	0	0	0	0	0	0	0
m. Arson	0	0	0	0	0	0	0	0	0
n. Simple assault	0	0	0	0	0	0	0	0	0
o. Larceny-theft	0	0	0	0	0	0	0	0	0
p. Intimidation	0	0	0	0	0	0	0	0	0
q. Destruction/damage/ vandalism of property	0	0	0	0	0	0	0	0	0





**SAN JOSÉ-EVERGREEN
COMMUNITY COLLEGE DISTRICT
POLICE DEPARTMENT**

SAN JOSÉ CITY COLLEGE

VAWA – On Campus

Total Occurrences On Campus			
Criminal Offense	2020	2021	2022
a. Domestic violence	0	0	0
b. Dating violence	0	0	0
c. Stalking	0	0	0

VAWA – Public Property

Total occurrences on Public Property			
Criminal Offense	2020	2021	2022
a. Domestic violence	0	0	0
b. Dating violence	0	0	0
c. Stalking	0	0	0

Arrests – On Campus

Total Occurrences On Campus			
Criminal Offense	2020	2021	2022
a. Weapons: Carrying, possessing etc.	0	1	0
b. Drug abuse violations	0	2	0
c. Liquor law violations	0	2	0

Arrests – Public Property

Total arrests on Public Property			
Criminal Offense	2020	2021	2022
a. Weapons: Carrying, possessing etc.	2	0	0
b. Drug abuse violations	0	0	0
c. Liquor law violations	0	0	0

Disciplinary Actions – On Campus

Total referred for disciplinary action			
Criminal Offense	2020	2021	2022
a. Weapons: Carrying, possessing etc.	0	0	0
b. Drug abuse violations	0	0	0
c. Liquor law violations	0	0	0

Disciplinary Actions – Public Property

Total referred for disciplinary action			
Criminal Offense	2020	2021	2022
a. Weapons: Carrying, possessing etc.	0	0	0
b. Drug abuse violations	0	0	0
c. Liquor law violations	1	0	0



SAN JOSÉ-EVERGREEN COMMUNITY COLLEGE DISTRICT POLICE DEPARTMENT

SJECCD MILPITAS EXTENSION

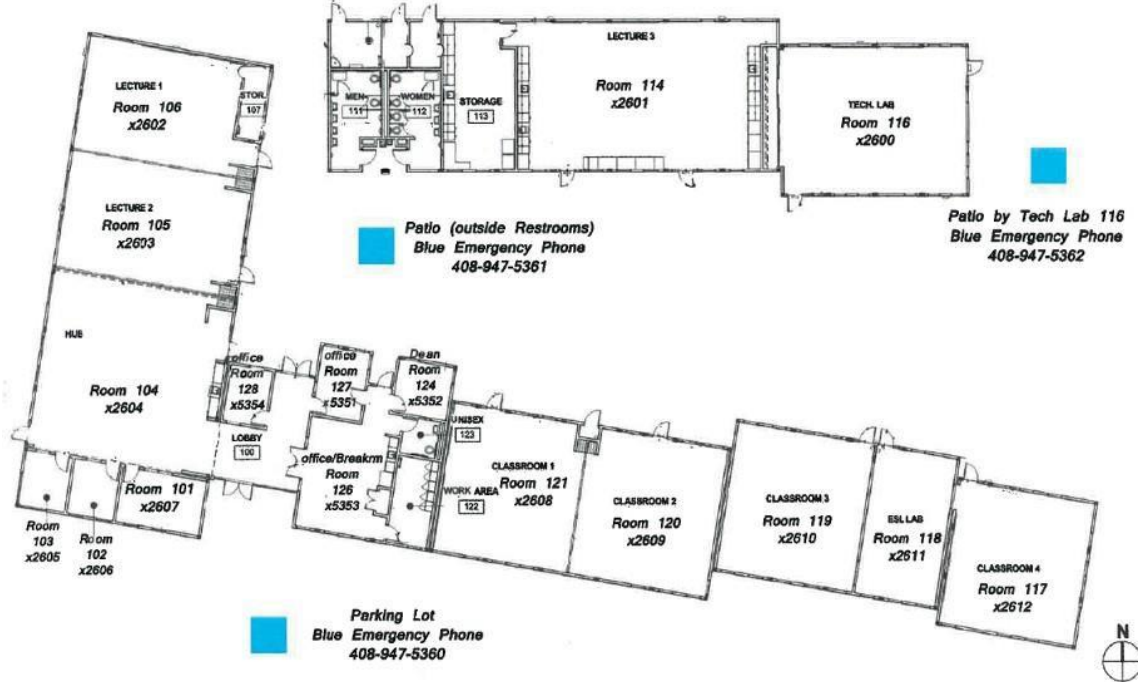

PARKING LOT





SAN JOSÉ-EVERGREEN COMMUNITY COLLEGE DISTRICT POLICE DEPARTMENT

SJECCD MILPITAS EXTENSION

<i>Criminal Offenses - On campus</i>			
Criminal Offense	<i>Total Occurrences – On Campus</i>		
	2020	2021	2022
a. Murder/Non-negligent manslaughter	0	0	0
b. Negligent manslaughter	0	0	0
c. Sex offenses - Forcible	0	0	0
d. Rape	0	0	0
e. Fondling	0	0	0
f. Sex offenses - Non-forcible	0	0	0
g. Incest	0	0	0
h. Statutory rape	0	0	0
i. Robbery	0	0	0
j. Aggravated assault	0	0	0
k. Burglary	0	0	0
l. Motor vehicle theft	0	0	0
m. Arson	0	0	0





SAN JOSÉ-EVERGREEN COMMUNITY COLLEGE DISTRICT POLICE DEPARTMENT

SJECCD MILPITAS EXTENSION

<i>Hate Crimes - On campus</i>									
Occurrences of Hate crimes									
Criminal offense									
<i>Category of Bias for crimes reported in 2022</i>									
Criminal offense	2022 Total	Race	Religion	Sexual Orientation	Gender	Gender Identity	Disability	Ethnicity	National Origin
a. Murder/ Non-negligent manslaughter	0	0	0	0	0	0	0	0	0
d. Rape	0	0	0	0	0	0	0	0	0
e. Fondling	0	0	0	0	0	0	0	0	0
g. Incest	0	0	0	0	0	0	0	0	0
h. Statutory rape	0	0	0	0	0	0	0	0	0
i. Robbery	0	0	0	0	0	0	0	0	0
j. Aggravated assault	0	0	0	0	0	0	0	0	0
k. Burglary	0	0	0	0	0	0	0	0	0
l. Motor vehicle theft	0	0	0	0	0	0	0	0	0
m. Arson	0	0	0	0	0	0	0	0	0
n. Simple assault	0	0	0	0	0	0	0	0	0
o. Larceny-theft	0	0	0	0	0	0	0	0	0
p. Intimidation	0	0	0	0	0	0	0	0	0
q. Destruction/damage/ vandalism of property	0	0	0	0	0	0	0	0	0

<i>Hate Crimes - On campus</i>									
Occurrences of Hate crimes									
Criminal offense									
<i>Category of Bias for crimes reported in 2021</i>									
Criminal offense	2021 Total	Race	Religion	Sexual Orientation	Gender	Gender Identity	Disability	Ethnicity	National Origin
a. Murder/ Non-negligent manslaughter	0	0	0	0	0	0	0	0	0
d. Rape	0	0	0	0	0	0	0	0	0
e. Fondling	0	0	0	0	0	0	0	0	0
g. Incest	0	0	0	0	0	0	0	0	0
h. Statutory rape	0	0	0	0	0	0	0	0	0
i. Robbery	0	0	0	0	0	0	0	0	0
j. Aggravated assault	0	0	0	0	0	0	0	0	0
k. Burglary	0	0	0	0	0	0	0	0	0
l. Motor vehicle theft	0	0	0	0	0	0	0	0	0
m. Arson	0	0	0	0	0	0	0	0	0
n. Simple assault	0	0	0	0	0	0	0	0	0
o. Larceny-theft	0	0	0	0	0	0	0	0	0
p. Intimidation	0	0	0	0	0	0	0	0	0
q. Destruction/damage/ vandalism of property	0	0	0	0	0	0	0	0	0



SAN JOSÉ-EVERGREEN COMMUNITY COLLEGE DISTRICT POLICE DEPARTMENT SJECCD MILPITAS EXTENSION

<i>Hate Crimes - On campus</i>									
Occurrences of Hate crimes									
Criminal offense									
<i>Category of Bias for crimes reported in 2020</i>									
Criminal offense	2020 Total	Race	Religion	Sexual Orientation	Gender	Gender Identity	Disability	Ethnicity	National Origin
a. Murder/ Non-negligent manslaughter	0	0	0	0	0	0	0	0	0
d. Rape	0	0	0	0	0	0	0	0	0
e. Fondling	0	0	0	0	0	0	0	0	0
g. Incest	0	0	0	0	0	0	0	0	0
h. Statutory rape	0	0	0	0	0	0	0	0	0
i. Robbery	0	0	0	0	0	0	0	0	0
j. Aggravated assault	0	0	0	0	0	0	0	0	0
k. Burglary	0	0	0	0	0	0	0	0	0
l. Motor vehicle theft	0	0	0	0	0	0	0	0	0
m. Arson	0	0	0	0	0	0	0	0	0
n. Simple assault	0	0	0	0	0	0	0	0	0
o. Larceny-theft	0	0	0	0	0	0	0	0	0
p. Intimidation	0	0	0	0	0	0	0	0	0
q. Destruction/damage/vandalism of property	0	0	0	0	0	0	0	0	0

VAWA – On Campus

Total Occurrences On Campus			
Criminal Offense	2020	2021	2022
a. Domestic violence	0	0	0
b. Dating violence	0	0	0
c. Stalking	0	0	0

Arrests – On Campus

Total Occurrences On Campus			
Criminal Offense	2020	2021	2022
a. Weapons: Carrying, possessing etc.	0	0	0
b. Drug abuse violations	0	0	0
c. Liquor law violations	0	0	0

Disciplinary Actions – On Campus

Total referred for disciplinary action			
Criminal Offense	2020	2021	2022
a. Weapons: Carrying, possessing etc.	0	0	0
b. Drug abuse violations	0	0	0
c. Liquor law violations	0	0	0



SAN JOSÉ-EVERGREEN COMMUNITY COLLEGE DISTRICT POLICE DEPARTMENT

EVERGREEN VALLEY COLLEGE

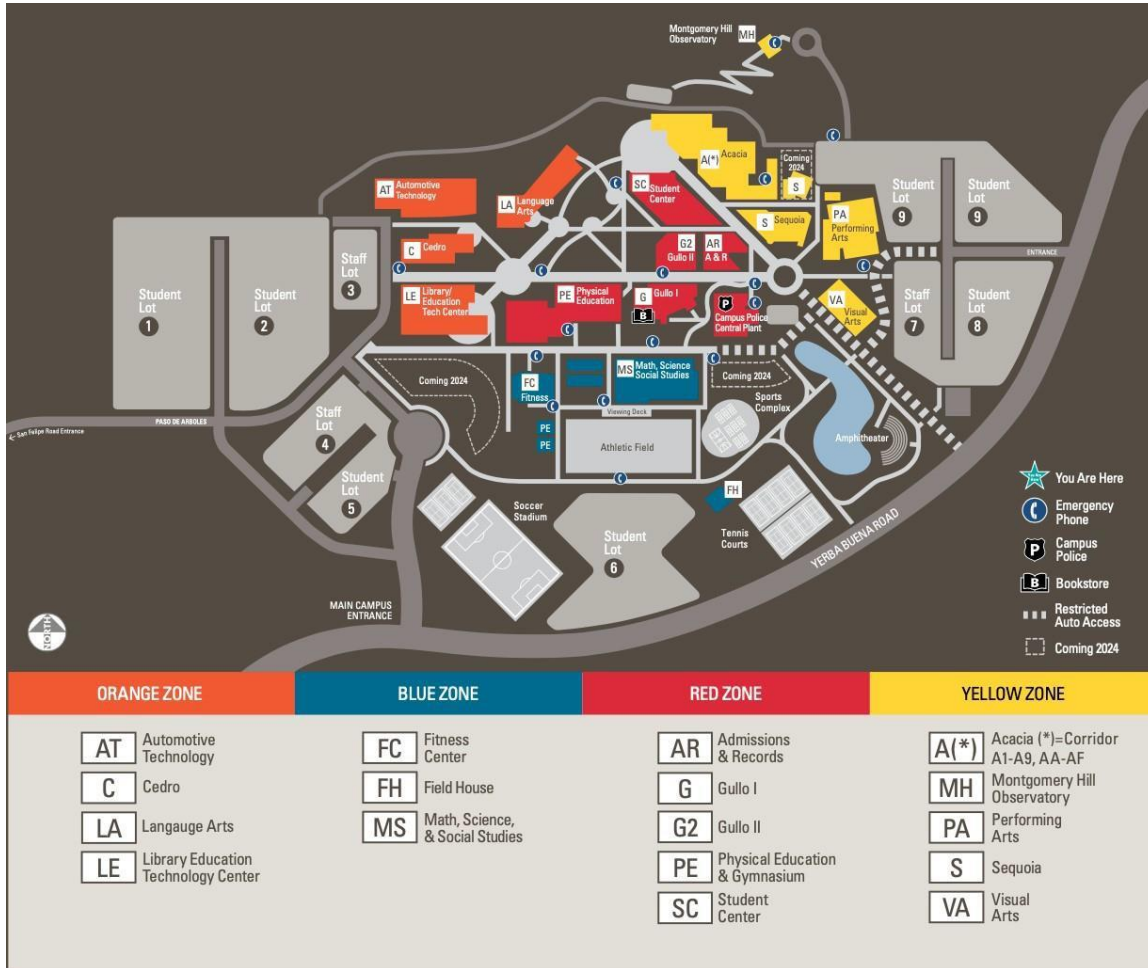



**SAN JOSÉ-EVERGREEN
COMMUNITY COLLEGE DISTRICT
POLICE DEPARTMENT**

EVERGREEN VALLEY COLLEGE

<i>Criminal Offenses - On campus</i>			
Criminal Offense	<i>Total Occurrences – On Campus</i>		
	2020	2021	2022
a. Murder/Non-negligent manslaughter	0	0	0
b. Negligent manslaughter	0	0	0
c. Sex offenses - Forcible	0	0	0
d. Rape	0	0	1
e. Fondling	0	0	0
f. Sex offenses - Non-forcible	0	0	0
g. Incest	0	0	0
h. Statutory rape	0	0	0
i. Robbery	0	0	0
j. Aggravated assault	0	0	0
k. Burglary	0	0	2
l. Motor vehicle theft	0	0	3
m. Arson	0	0	0

<i>Criminal Offenses – Public Property</i>			
Criminal Offense	<i>Total Occurrences – Public Property</i>		
	2020	2021	2022
a. Murder/Non-negligent manslaughter	0	0	0
b. Negligent manslaughter	0	0	0
c. Sex offenses - Forcible	0	0	0
d. Rape	0	0	0
e. Fondling	0	0	0
f. Sex offenses - Non-forcible	0	0	0
g. Incest	0	0	0
h. Statutory rape	0	0	0
i. Robbery	0	0	0
j. Aggravated assault	0	0	0
k. Burglary	0	0	0
l. Motor vehicle theft	0	0	0
m. Arson	0	0	0



SAN JOSÉ-EVERGREEN COMMUNITY COLLEGE DISTRICT POLICE DEPARTMENT

EVERGREEN VALLEY COLLEGE

<i>Hate Crimes - On campus</i>										
Occurrences of Hate crimes										
Criminal offense										
<i>Category of Bias for crimes reported in 2022</i>										
Criminal offense	2022 Total	Race	Religion	Sexual Orientation	Gender	Gender Identity	Disability	Ethnicity	National Origin	
a. Murder/ Non-negligent manslaughter	0	0	0	0	0	0	0	0	0	
d. Rape	0	0	0	0	0	0	0	0	0	
e. Fondling	0	0	0	0	0	0	0	0	0	
g. Incest	0	0	0	0	0	0	0	0	0	
h. Statutory rape	0	0	0	0	0	0	0	0	0	
i. Robbery	0	0	0	0	0	0	0	0	0	
j. Aggravated assault	0	0	0	0	0	0	0	0	0	
k. Burglary	0	0	0	0	0	0	0	0	0	
l. Motor vehicle theft	0	0	0	0	0	0	0	0	0	
m. Arson	0	0	0	0	0	0	0	0	0	
n. Simple assault	0	0	0	0	0	0	0	0	0	
o. Larceny-theft	0	0	0	0	0	0	0	0	0	
p. Intimidation	0	0	0	0	0	0	0	0	0	
q. Destruction/damage/vandalism of property	0	0	0	0	0	0	0	0	0	

<i>Hate Crimes - On campus</i>										
Occurrences of Hate crimes										
Criminal offense										
<i>Category of Bias for crimes reported in 2021</i>										
Criminal offense	2021 Total	Race	Religion	Sexual Orientation	Gender	Gender Identity	Disability	Ethnicity	National Origin	
a. Murder/ Non-negligent manslaughter	0	0	0	0	0	0	0	0	0	
d. Rape	0	0	0	0	0	0	0	0	0	
e. Fondling	0	0	0	0	0	0	0	0	0	
g. Incest	0	0	0	0	0	0	0	0	0	
h. Statutory rape	0	0	0	0	0	0	0	0	0	
i. Robbery	0	0	0	0	0	0	0	0	0	
j. Aggravated assault	0	0	0	0	0	0	0	0	0	
k. Burglary	0	0	0	0	0	0	0	0	0	
l. Motor vehicle theft	0	0	0	0	0	0	0	0	0	
m. Arson	0	0	0	0	0	0	0	0	0	
n. Simple assault	0	0	0	0	0	0	0	0	0	
o. Larceny-theft	0	0	0	0	0	0	0	0	0	
p. Intimidation	0	0	0	0	0	0	0	0	0	
q. Destruction/damage/vandalism of property	0	0	0	0	0	0	0	0	0	



SAN JOSÉ-EVERGREEN COMMUNITY COLLEGE DISTRICT POLICE DEPARTMENT

EVERGREEN VALLEY COLLEGE

<i>Hate Crimes - On campus</i>									
Occurrences of Hate crimes									
Criminal offense									
<i>Category of Bias for crimes reported in 2020</i>									
Criminal offense	2020 Total	Race	Religion	Sexual Orientation	Gender	Gender Identity	Disability	Ethnicity	National Origin
a. Murder/ Non-negligent manslaughter	0	0	0	0	0	0	0	0	0
d. Rape	0	0	0	0	0	0	0	0	0
e. Fondling	0	0	0	0	0	0	0	0	0
g. Incest	0	0	0	0	0	0	0	0	0
h. Statutory rape	0	0	0	0	0	0	0	0	0
i. Robbery	0	0	0	0	0	0	0	0	0
j. Aggravated assault	0	0	0	0	0	0	0	0	0
k. Burglary	0	0	0	0	0	0	0	0	0
l. Motor vehicle theft	0	0	0	0	0	0	0	0	0
m. Arson	0	0	0	0	0	0	0	0	0
n. Simple assault	0	0	0	0	0	0	0	0	0
o. Larceny-theft	0	0	0	0	0	0	0	0	0
p. Intimidation	0	0	0	0	0	0	0	0	0
q. Destruction/damage/ vandalism of property	1	1	0	0	0	0	0	0	0

<i>Hate Crimes – Public Property</i>									
Occurrences of Hate crimes									
Criminal offense									
<i>Category of Bias for crimes reported in 2022</i>									
Criminal offense	2022 Total	Race	Religion	Sexual Orientation	Gender	Gender Identity	Disability	Ethnicity	National Origin
a. Murder/ Non-negligent manslaughter	0	0	0	0	0	0	0	0	0
d. Rape	0	0	0	0	0	0	0	0	0
e. Fondling	0	0	0	0	0	0	0	0	0
g. Incest	0	0	0	0	0	0	0	0	0
h. Statutory rape	0	0	0	0	0	0	0	0	0
i. Robbery	0	0	0	0	0	0	0	0	0
j. Aggravated assault	0	0	0	0	0	0	0	0	0
k. Burglary	0	0	0	0	0	0	0	0	0
l. Motor vehicle theft	0	0	0	0	0	0	0	0	0
m. Arson	0	0	0	0	0	0	0	0	0
n. Simple assault	0	0	0	0	0	0	0	0	0
o. Larceny-theft	0	0	0	0	0	0	0	0	0
p. Intimidation	0	0	0	0	0	0	0	0	0
q. Destruction/damage/ vandalism of property	0	0	0	0	0	0	0	0	0



**SAN JOSÉ-EVERGREEN
COMMUNITY COLLEGE DISTRICT
POLICE DEPARTMENT
EVERGREEN VALLEY COLLEGE**

<i>Hate Crimes – Public Property</i>									
Occurrences of Hate crimes									
Criminal offense									
<i>Category of Bias for crimes reported in 2021</i>									
Criminal offense	2021 Total	Race	Religion	Sexual Orientation	Gender	Gender Identity	Disability	Ethnicity	National Origin
a. Murder/ Non-negligent manslaughter	0	0	0	0	0	0	0	0	0
d. Rape	0	0	0	0	0	0	0	0	0
e. Fondling	0	0	0	0	0	0	0	0	0
g. Incest	0	0	0	0	0	0	0	0	0
h. Statutory rape	0	0	0	0	0	0	0	0	0
i. Robbery	0	0	0	0	0	0	0	0	0
j. Aggravated assault	0	0	0	0	0	0	0	0	0
k. Burglary	0	0	0	0	0	0	0	0	0
l. Motor vehicle theft	0	0	0	0	0	0	0	0	0
m. Arson	0	0	0	0	0	0	0	0	0
n. Simple assault	0	0	0	0	0	0	0	0	0
o. Larceny-theft	0	0	0	0	0	0	0	0	0
p. Intimidation	0	0	0	0	0	0	0	0	0
q. Destruction/damage/ vandalism of property	0	0	0	0	0	0	0	0	0

<i>Hate Crimes – Public Property</i>									
Occurrences of Hate crimes									
Criminal offense									
<i>Category of Bias for crimes reported in 2020</i>									
Criminal offense	2020 Total	Race	Religion	Sexual Orientation	Gender	Gender Identity	Disability	Ethnicity	National Origin
a. Murder/ Non-negligent manslaughter	0	0	0	0	0	0	0	0	0
d. Rape	0	0	0	0	0	0	0	0	0
e. Fondling	0	0	0	0	0	0	0	0	0
g. Incest	0	0	0	0	0	0	0	0	0
h. Statutory rape	0	0	0	0	0	0	0	0	0
i. Robbery	0	0	0	0	0	0	0	0	0
j. Aggravated assault	0	0	0	0	0	0	0	0	0
k. Burglary	0	0	0	0	0	0	0	0	0
l. Motor vehicle theft	0	0	0	0	0	0	0	0	0
m. Arson	0	0	0	0	0	0	0	0	0
n. Simple assault	0	0	0	0	0	0	0	0	0
o. Larceny-theft	0	0	0	0	0	0	0	0	0
p. Intimidation	0	0	0	0	0	0	0	0	0
q. Destruction/damage/ vandalism of property	0	0	0	0	0	0	0	0	0



**SAN JOSÉ-EVERGREEN
COMMUNITY COLLEGE DISTRICT
POLICE DEPARTMENT

EVERGREEN VALLEY COLLEGE**

VAWA – On Campus

Criminal Offense	Total Occurrences On Campus		
	2020	2021	2022
a. Domestic violence	0	0	1
b. Dating violence	1	0	0
c. Stalking	0	0	0

VAWA – Public Property

Criminal Offense	Total occurrences on Public Property		
	2020	2021	2022
a. Domestic violence	1	0	1
b. Dating violence	0	0	0
c. Stalking	0	0	0

Arrests – On Campus

Criminal Offense	Total Occurrences On Campus		
	2020	2021	2022
a. Weapons: Carrying, possessing etc.	0	0	0
b. Drug abuse violations	1	0	0
c. Liquor law violations	0	0	0

Arrests – Public Property

Criminal Offense	Total arrests on Public Property		
	2020	2021	2022
a. Weapons: Carrying, possessing etc.	0	0	0
b. Drug abuse violations	0	0	0
c. Liquor law violations	0	0	0

Disciplinary Actions – On Campus

Criminal Offense	Total referrals for disciplinary action		
	2020	2021	2022
a. Weapons: Carrying, possessing etc.	0	0	0
b. Drug abuse violations	0	0	0
c. Liquor law violations	0	0	0

Disciplinary Actions – Public Property

Criminal Offense	Total referrals for disciplinary action		
	2020	2021	2022
a. Weapons: Carrying, possessing etc.	0	0	0
b. Drug abuse violations	0	0	0
c. Liquor law violations	0	0	0