



# **FUTURE FOCUSED FORWARD READY**

Facilities Master Plan (FMP)

**PROGRESS UPDATE TO THE  
BOARD OF TRUSTEES**

December 17, 2024



# Approach & Overview

# Facilities Master Plan (FMP) Task Force

COMPRISED OF STUDENTS, CLASSIFIED, FACULTY AND ADMINISTRATION

## EVC

- **Angel Fuentes** - Academic Division Dean
- **Kathy Tran** - Finance/ Business Service Representative
- **Michael Osorio** - Student Division Dean/Director
- **Henry Estrada** - Faculty Representative
- **Josephine Aguirre** - Classified Professional Representative
- **Edgar Jimenez Granados** - Student Representative

## DISTRICT

- **Edwin Chandrasekar** - Project Sponsor/Facilitator
- **Toby Smith** - AVC Physical Plant Development and Operations
- **Sue Dale** - District Managed Facilities
- **Bala Kappagantula** - Information Technology Representative
- **Ryan Brown** - Public Information Officer

## SJCC

- **Misty Stroud** - Academic Division Dean
- **Saloshni Chand** - Finance/ Business Service Representative
- **Blake Balajadia** - Student Division Dean/Director
- **Mark Branom** - Faculty Representative
- **Yesenia Ramirez** - Classified Professional Representative
- **Pratham Tated** - Student Representative

## ARCHITECTS AND PLANNERS

- **Christen Soares** – Architect and Principle, Field Paoli
- **Jane Lin** – Architect and Founder, Urban Design Studio
- **Christina Paul** – Principle, Cygnus Planning
- **Yann Taylor** – Architect, Field Paoli

FUTURE FOCUSED  
FORWARD READY

# Timeline and Project Phases

APRIL 2024 – AUGUST 2025

## SPRING - SUMMER 2024

### Phase 1: Kickoff + Data Gathering

Project Initiation, Group kick off meetings, tours, interviews, data gathering and analysis

## SPRING - SUMMER 2025

### Phase 3: Draft Plan and Feedback

Drafting the plan, developing cost estimates and prioritizing projects

## FALL - WINTER 2024-2025

### Phase 2: Existing Conditions + Vision

Outreach to the campus communities, sharing Existing Conditions, and developing a Vision

## FALL 2025

### Phase 3: Final Plan + Adoption

Finalizing the plan, presenting it to leadership, and preparing for adoption

FUTURE FOCUSED  
FORWARD READY

FIELD  
PAOLI



SAN JOSÉ · EVERGREEN  
Community College District

# Outreach and Engagement

## MULTI-MODAL AND MIXED METHODS APPROACH: SURVEY SUMMARY

### LOCATION

SJCC	52%
EVC	43%
District Office	3%
Milpitas	2%

517 Survey Responses

### REPRESENTATIVE GROUPS

Students	64%
Faculty	18%
Classified Professor	14%
Management	4%

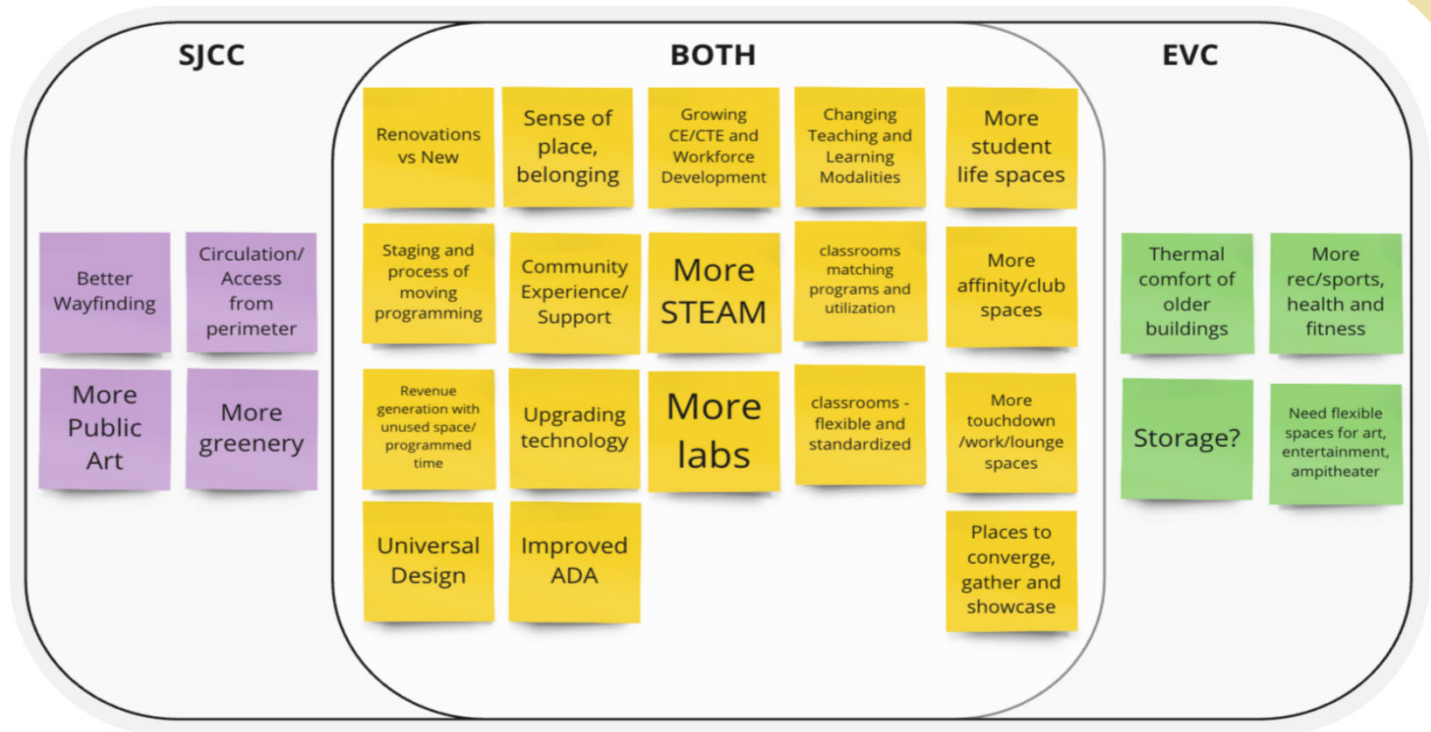

FUTURE FOCUSED  
FORWARD READY

# Outreach and Engagement

## MULTI-MODAL AND MIXED METHODS APPROACH: SITE VISITS AND DATA GATHERING

### CAMPUS SITE TOURS:

- Public Spaces and Public Life (PSPL)
- Buildings at SJCC, EVC, Milpitas
- Mechanical Electrical Plumbing (MEP)

### DATA GATHERING:

- Review of Enrollment
- Programs/Courses
- Class Scheduling

### EXISTING REPORTS:

- 2021 Facilities Condition Assessment
- Districtwide Strategic Plan
- Educational Master Plans
- 2017 Facilities Master Plan
- Scheduled Maintenance List
- ADA Assessments



FUTURE FOCUSED  
FORWARD READY

FIELD  
PAOLI



SAN JOSÉ · EVERGREEN  
Community College District

# Outreach and Engagement

## MULTI-MODAL AND MIXED METHODS APPROACH: STUDENT AND EMPLOYEE VOICES

### STUDENT FOCUS GROUPS

- Student Lunch and Learn

### EMPLOYEE FOCUS GROUPS

- Classified Professionals
- Faculty
- Administrators



### MANAGEMENT PARTICIPATION

- |  |                     |
|--|---------------------|
| • EVC VP Academic Affairs                              | Matais Pouncil      |
| • EVC VP Student Affairs                               | Howard Willis       |
| • EVC VP Administrative Affairs                        | Andrea Alexander    |
| • EVC Facilities Department Manager                    | Vincent Cabada      |
| • EVC Student Development Director                     | Raniyah Johnson     |
| • SJCC VP Academic Affairs                             | Jamail Carter       |
| • SJCC VP Student Affairs                              | William Garcia      |
| • SJCC VP Administrative Services                      | Chris Hawken        |
| • SJCC VP Strategic Partners and Workforce Development | Maniphone Dickerson |
| • SJCC Facilities Department Manager                   | Joe Andrade         |
| • SJCC Student Development Director                    | Blake Balajadia     |
| • Districtwide Managed Facilities                      | Susan Dale          |
| • Districtwide Facilities Maintenance                  | Art Rodriguez       |

FUTURE FOCUSED  
FORWARD READY

FIELD  
PAOLI



SAN JOSÉ · EVERGREEN  
Community College District

# Outreach and Engagement

## MULTI-MODAL AND MIXED METHODS APPROACH: PROJECT WEBSITE

The screenshot shows the website for the Facilities Master Plan Task Force. The header includes the San José Evergreen Community College District logo, navigation links (About SJECCD, Community, District Committees & Governance Groups, District Departments, Leadership), and utility links (SSO LOGIN, FOUNDATION, INFORMATION, QUICK LINKS). The main content area is titled "Facilities Master Plan Task Force" and "2024 Facilities Master Plan (FMP) Development". It provides a brief overview of the FMP process, a link to the "FMP Task Force" page, and a section for "FMP Outreach Meetings" listing various meetings and their dates. A "Section Links" sidebar on the left includes links to "Facilities Master Plan Task Force" and "Maintenance", and a "Have feedback to share on the Facilities Master Plan?" section with a "WEB SURVEY" button.

**Section Links**

- [Facilities Master Plan Task Force](#)
- [Maintenance](#)

**Have feedback to share on the Facilities Master Plan?**  
You can do so via this brief

[WEB SURVEY](#)

### Facilities Master Plan Task Force

#### 2024 Facilities Master Plan (FMP) Development

The last Facilities Master Plan (FMP) for EVC and SJCC was conducted in 2016, and the district is taking next steps to develop a districtwide refresh of the FMP. The District has engaged Field Paoli, an architecture firm with campus planning specialty, to guide and create this updated FMP.

#### FMP Task Force

The district reached out to the Academic Senate, Classified Senate, and Student Government Association to request representatives to serve on the Facilities Master Plan Task Force. All names forwarded via the constituent groups were invited to serve on the Task Force. The Task Force will serve as an advisory group to provide collective feedback on the long-term (10 year and beyond) campus facilities based on survey findings, key informant interviews and facilities condition assessments.

**Expected Task Force Duration: May 2024 to August 2025**

#### FMP Outreach Meetings

The District has conducted a series of outreach meetings related to the Facilities Master Plan. We want to thank the many students, classified professionals, faculty, and others who participated and took the time provide valuable input to the FMP process.

- [EVC Classified Professionals 10.22.24](#)
- [EVC Lunch and Learn 10.17.24](#)
- [SJCC Classified Professionals Meeting 10.23.24](#)
- [SJCC Lunch and Learn 10.21.24](#)
- [SJECCD District-wide Faculty Meeting 10.25.24](#)

[HTTPS://SJECCD.EDU/FACILITIES-MASTER-PLAN-TASK-FORCE](https://sjeccd.edu/facilities-master-plan-task-force)

### CONTENT:

- Outreach meeting presentations
- FMP Task Force Membership
- Key Dates
- Resources
- Existing Conditions Report and Appendices

FIELD  
PAOLI



SAN JOSÉ · EVERGREEN  
Community College District



# Existing Conditions Report

FINDINGS AND EMERGING THEMES



# Public Space and Public Life

## THINKING ABOUT THE WHOLE BUILT ENVIRONMENT

The spaces between campus buildings, otherwise known as the PUBLIC REALM, have a critical role in

- establishing the image of the campus
- ensuring site functionality, and
- increasing the overall quality of life for students, employees, and visitors



### REIMAGINING OUR CAMPUSES

Everyone experiences the public realm on campus grounds. The design of outdoor spaces can create a vibrant, attractive, and inviting place and be a reason to come to campus.

FUTURE FOCUSED  
FORWARD READY

# Designing Public Spaces for Enjoyment

CREATING OPPORTUNITIES TO WALK/BIKE, STOP/STAY, SIT, SEE, TALK/LISTEN, PLAY

FUTURE FOCUSED  
FORWARD READY





# Creating a Center

ACTIVATING THE SENSES, CULTIVATING VIBRANCY, ATTRACTING PEOPLE TO CAMPUSES

FUTURE FOCUSED  
FORWARD READY





# Strengthening Connections

CONNECTING TO EACH OTHER, TO THE ENVIRONMENT, AND FOR UNIVERSAL ACCESS

FUTURE FOCUSED  
FORWARD READY



# Public Space and Public Life

## ISSUES AND OPPORTUNITIES

ISSUE	OPPORTUNITY	EVC	SJCC
Inactive/Empty open space	• Make spaces more fun	X	X
	• Provide more outdoor seating	X	X
	• Improve outdoor seating for more flexibility	X	X
Missing a Center/Central Organizing Element	• Designate a center		X
	• Activate focal points on campus	X	X
	• Edit outdoor features		X
	• Hone the landscaping and furnishing palette	X	X
Campus Edges need attention	• Provide a “front door” on Moorpark Ave		X
	• Improve the Bascom Ave entry		X
	• Create a new campus entry on Leigh Ave		X
	• Add a landscape buffer between campus and residential		X
Circulation challenges	• Remove stairs to improve accessibility	X	
	• Refine pathways to follow desired pathways	X	X

FUTURE FOCUSED  
FORWARD READY





**ADA Improvements**



**Add Outdoor Seating**



**Plaza Renovation for Activation**



**Library/SC Plaza Renovation**



**SC/Gym Plaza Renovation**



**Cosmetology Plaza Renovation**





# Facilities

## ISSUES AND OPPORTUNITIES

ISSUE	OPPORTUNITY
Aging Infrastructure and Maintenance Needs	Improve Infrastructure and Operate More Effectively
Sustainability Challenges	Adopt Sustainability Initiatives
Declining Enrollment and Shifts in Instructional Mode	Update Learning Spaces
Space Utilization and Low Fill Rates	Space Optimization and Repurposing
Lack of Student-Centric Spaces	Create more Student-Centered Facilities
Navigation, Wayfinding, and Campus Identity	Improve Campus Public Realm and Strengthen the Sense of Place

FUTURE FOCUSED  
FORWARD READY



# Academic Spaces

CONSOLIDATE, UPGRADE, AND INCREASE UTILIZATION



- Outdated classroom technology and furniture (FF&E)
- Need for online teaching facilities
- Need for testing spaces for DSP accommodations
- Need for more laboratory and improvements to existing laboratories
- Desire for makerspaces

FUTURE FOCUSED  
FORWARD READY

# Office Spaces

STRATEGICALLY LOCATE AND IMPROVE USER EXPERIENCE



- Not enough privacy
- Acoustics are challenging
- Not enough security
- Too much HVAC and energy use

FUTURE FOCUSED  
FORWARD READY

# Student Campus Life Spaces

ADD MORE STUDENT-CENTERED SPACES THROUGHOUT CAMPUSES

FUTURE FOCUSED  
FORWARD READY



- Lack of group study (collaboration) rooms
- Lack of touchdown spaces/student lounges
- Lack of club spaces
- Lack of places to get food
- Restrooms need improvement
- Basic needs in more places
- Lack of meeting and event spaces



# Maintenance Spaces

IMPROVE FOR OPTIMIZING OPERATIONS



- Not enough storage for custodial or maintenance
- Need more maintenance safety and access

FUTURE FOCUSED  
FORWARD READY

# Next Steps

OUR PROGRESS FORWARD



# Emerging Vision

## FRAMEWORK FOR PRIORITIZING PROJECTS

- Address capital replacement and renewals (scheduled and deferred maintenance)
- Bring safety, health, universal access, and IT up to current standards
- Upgrade campus infrastructure for sustainability
- Consolidate programming, use space more efficiently
- Increase campus vibrancy
- Create more student-centered spaces
- Continue to support the teaching and learning experience

FUTURE FOCUSED  
FORWARD READY

# Considerations that affect Facilities Planning

## ALIGNMENT WITH STRATEGIC MISSION AND EDUCATIONAL MASTER PLANS

- Future student segments markets given changing demographic
- Academic Programming and Support Services
- Modes of Instruction
- Scheduling Patterns
- Space Needs and Usage

FUTURE FOCUSED  
FORWARD READY

# Emerging Project List

EVERGREEN VALLEY  
COLLEGE

Building Name	Condition ranking (1 Low - 5 High)	Recommended Improvement	Opportunity
Acacia	1	Remove	Improved connections
Sequoia	3	Renovate	Laboratories
Central Plant	4	Renovate	Whole system
Physical Education & Gymnasium	3	Renovate	Locker Rooms and Gymnasium
(Old) Student Services Center *	3	Repurpose or Remove	
Gullo I*	2	Renovate/Repurpose	
Library/ Education Tech Center*	3	Renovate/Repurpose	
Admissions & Records*	3	Renovate/Repurpose	
District Office		Potentially Relocate	
Basic Needs Center		Potentially New	
Childcare		Potentially New	
ESports and Gaming Room		Potentially New	
Laboratories		Potentially New	
Maker Space/Innovation Lab		Potentially New	
Meditation Rooms		Potentially New	
Museum		Potentially New	
Places to get Food		Potentially New	
Student Activity Center		Potentially New	
Student Hub		Potentially New	

FUTURE FOCUSED  
FORWARD READY



# Reimagining the Campus

## EVERGREEN VALLEY COLLEGE

AR ADMINISTRATION  
 SC STUDENT CENTER  
 AT AUTOMOTIVE TECHNOLOGY  
 C CEDRO  
 CDC CHILD DEVELOPMENT CENTER  
 LA LANGUAGE ARTS  
 LE LIBRARY/ EDUCATION TECH  
 CENTER  
 FC FITNESS CENTER  
 PE PHYSICAL EDUCATION & GYM  
 CP CAMPUS POLICE AND CENTRAL  
 PLAN  
 G GULLO I  
 G2 GULLO II  
 A ACACIA  
 MH MONTGOMERY HILL OBSERVATORY  
 PA PERFORMING ARTS  
 VA VISUAL ARTS  
 SQ SEQUOIA  
 MS MATH SCIENCE BUILDING  
 N NURSING  
 FC FITNESS CENTER  
 GE GENERAL EDUCATION  
 S STUDENT SERVICES  
 FH FIELD HOUSE

POTENTIAL BUILDING PROJECTS  
 POTENTIAL GROUNDS PROJECTS  
 DEMOLITION

0 100 200 400

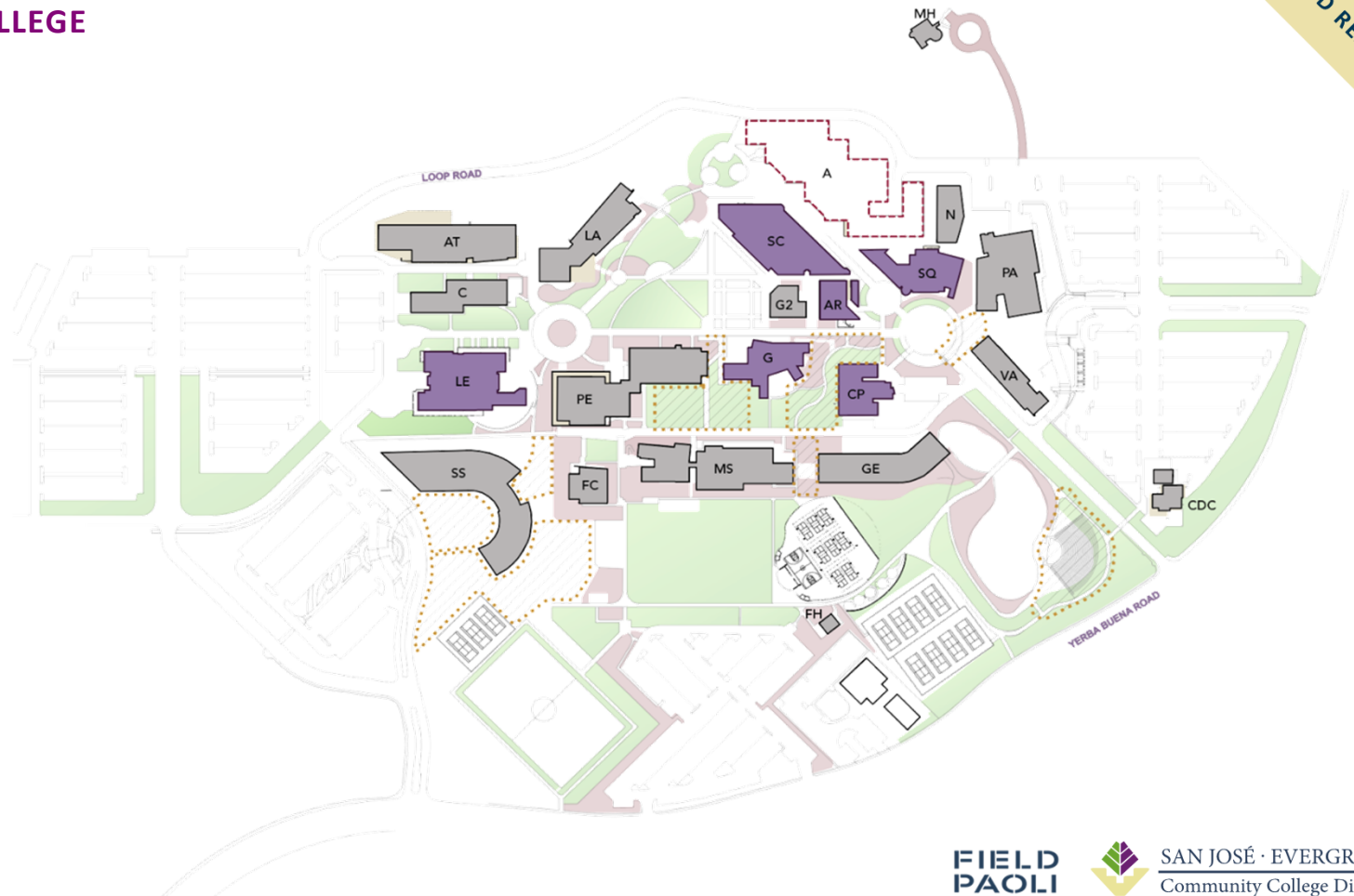

FUTURE FOCUSED  
 FORWARD READY

FIELD  
 PAOLI



SAN JOSÉ · EVERGREEN  
 Community College District

# Emerging Project List

SAN JOSÉ CITY COLLEGE

Building Name	Condition Ranking (1 low - 5 high)	Recommended Improvement	Opportunity
100 Building	1	Removal	Relocate Adaptive PE
Cosmetology	3	Renovate	Expansion into Reprographics
Jaguar Gym	2	Renovate	Gymnasium edges
Reprographics	3	Repurpose	Relocate off-site
Science Complex	3	Renovate	Lab conversions
Wellness Center	5	Repurpose	Relocate Adaptive PE
<b>Business Education*</b>	<b>2</b>	<b>Removal, Renovate, or Replace</b>	<b>Whole building</b>
<b>General Education*</b>	<b>3</b>	<b>Removal, Renovate, or Replace</b>	<b>Whole building</b>
<b>Student Center*</b>	<b>4</b>	<b>Repurpose</b>	<b>Bookstore and Cafeteria</b>
<b>Technology Center*</b>	<b>3</b>	<b>Repurpose</b>	<b>Whole building</b>
<b>Theater Arts*</b>	<b>1</b>	<b>Removal, Renovate, or Replace</b>	<b>Whole building</b>
(Potential) Building on Bascom Parking Lot	N/A	Potentially New	Replaces Building 100
(Potential) Central Building	N/A	Potentially New	Replaces central buildings
Admin and Finance		Potentially Relocate	
Dental Program		Potentially Relocate	
District Office		Potentially Relocate	
President's Office		Potentially Relocate	
Basic Needs Center		Potentially New	
Childcare Center		Potentially New	
Club spaces		Potentially New	
Community Hub		Potentially New	
Event spaces and meeting spaces		Potentially New	
Housing		Potentially New	
Laboratories		Potentially New	
Multicultural Complex		Potentially New	
Places to get food		Potentially New	
Student Lounge		Potentially New	

FUTURE FOCUSED  
FORWARD READY



SAN JOSÉ · EVERGREEN  
Community College District

# Reimagining the Campus

## SAN JOSÉ CITY COLLEGE

- 100 100 BUILDING
- 200 200 BUILDING
- THR THEATER
- JG JAGUAR GYM
- B BUSINESS EDUCATION
- WC WELLNESS CENTER
- C COSMETOLOGY
- D DRAMA
- GE GENERAL EDUCATION
- L LIBRARY
- T TECHNOLOGY CENTER
- SC STUDENT CENTER
- S SCIENCE COMPLEX
- CT CAREER TECHNOLOGY
- A FINE ARTS CENTER
- JC JAGUAR SPORTS COMPLEX
- M MULTIDISCIPLINARY
- R REPROGRAPHICS
- CEC CAREER EDUCATION COMPLEX

- POTENTIAL BUILDING PROJECTS
- POTENTIAL GROUNDS PROJECTS
- DEMOLITION

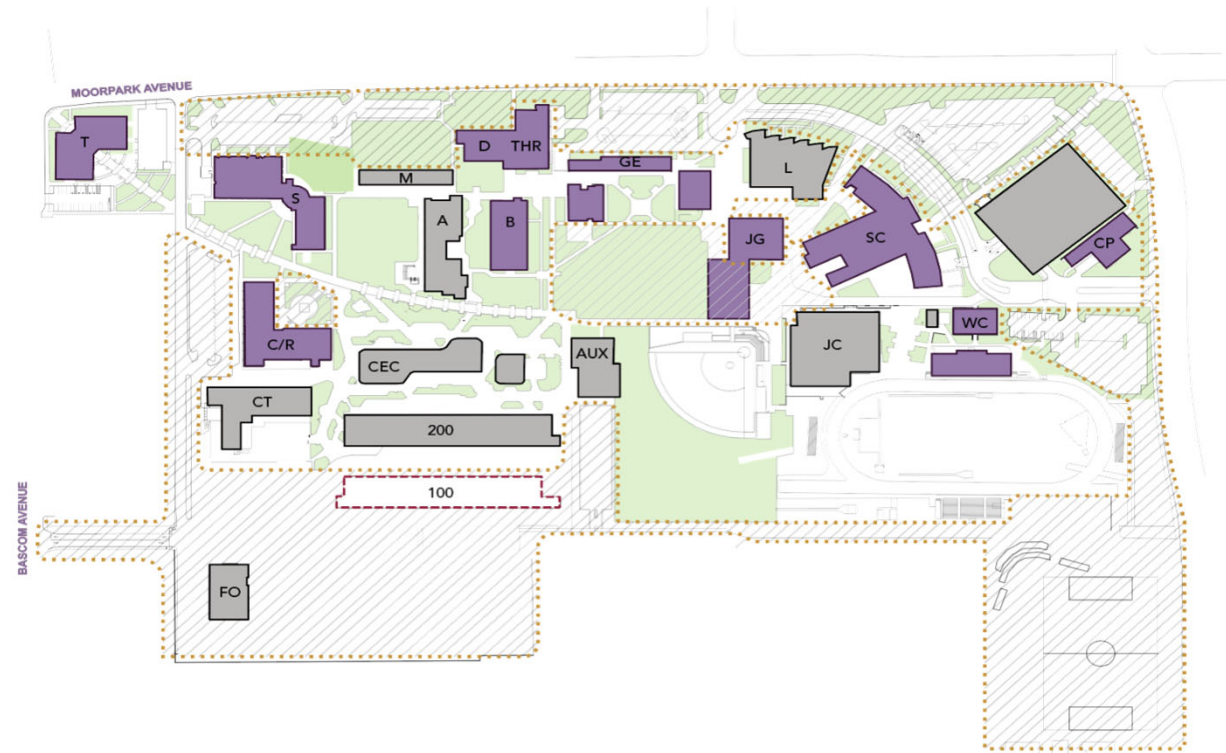

FUTURE FOCUSED  
FORWARD READY

**FIELD  
PAOLI**



**SAN JOSÉ · EVERGREEN**  
Community College District

# Phase 3

APRIL 2024 – AUGUST 2025

## SPRING - SUMMER 2024

### Phase 1: Kickoff + Data Gathering

Project Initiation, Group kick off meetings, tours, interviews, data gathering and analysis

## SPRING - SUMMER 2025

### Phase 3: Draft Plan and Feedback

Drafting the plan, developing cost estimates and prioritizing projects

## FALL - WINTER 2024-2025

### Phase 2: Existing Conditions + Vision

Outreach to the campus communities, sharing Existing Conditions, and developing a Vision

## FALL 2025

### Phase 3: Final Plan + Adoption

Finalizing the plan, presenting it to leadership, and preparing for adoption

FUTURE FOCUSED  
FORWARD READY

FIELD  
PAOLI



SAN JOSÉ · EVERGREEN  
Community College District



# Q&A

THANK YOU!

